

**ECLATEC**

**CADIX**



IEC  
EN 60598

**IP66**



**RoHS**

**220-240V 50Hz**

<b>H max</b>	<b>IK</b>	 <b>kg</b>	<b>SCx</b>
1m	07	15kg	

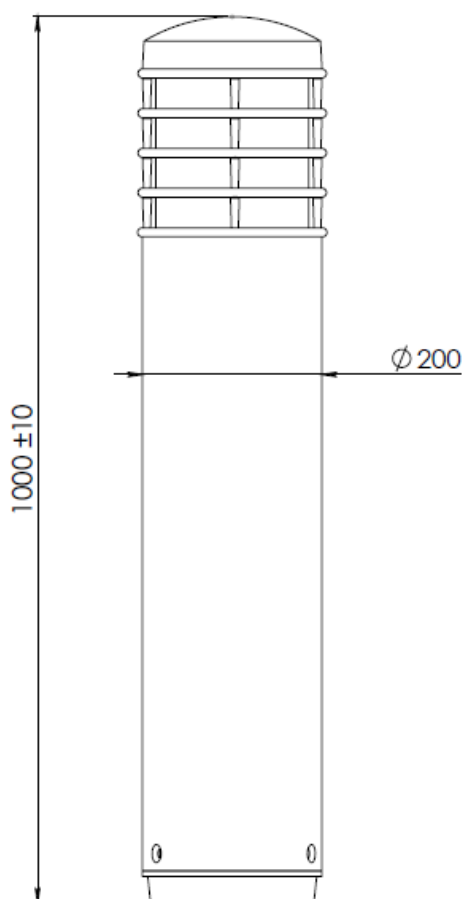

Vérifier que l'alimentation soit coupée avant toute intervention dans le luminaire  
Toute intervention doit se faire par du personnel qualifié et habilité

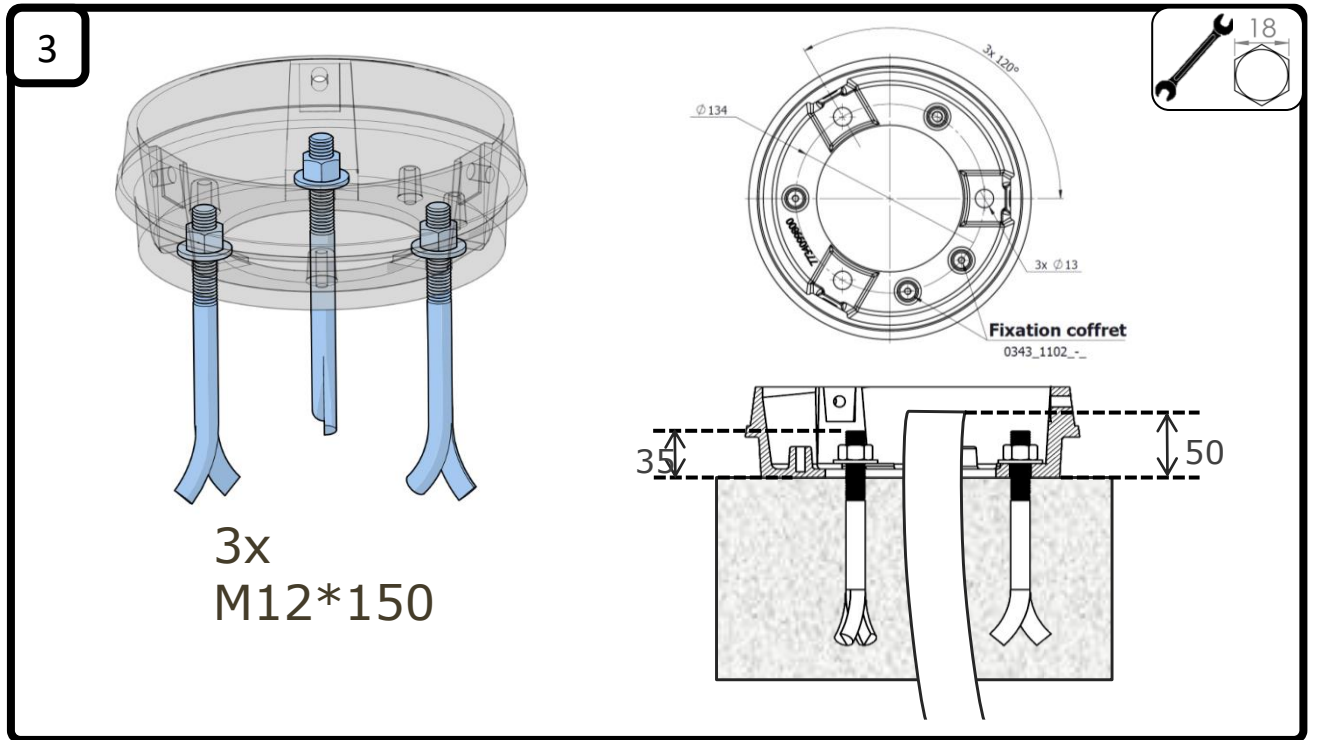
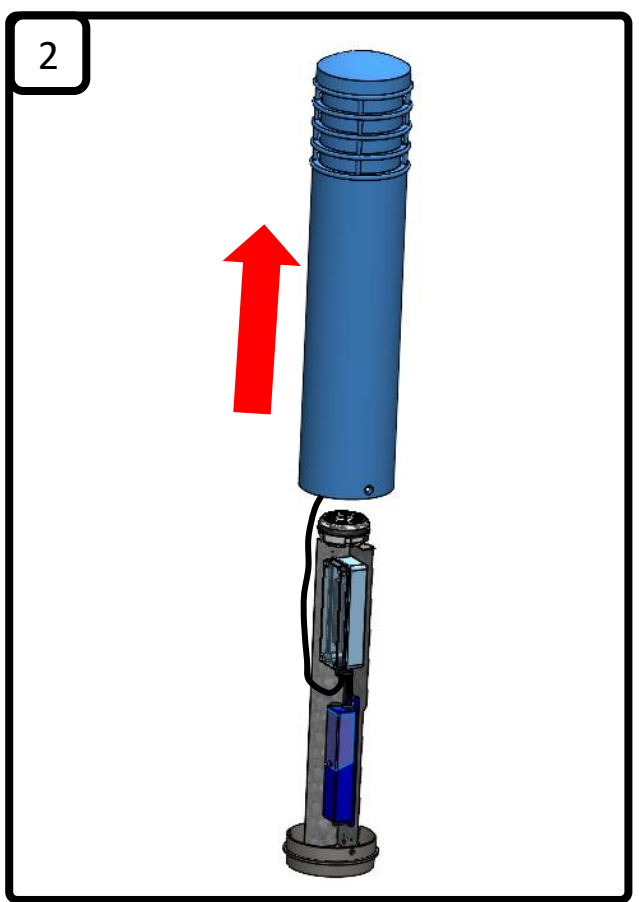
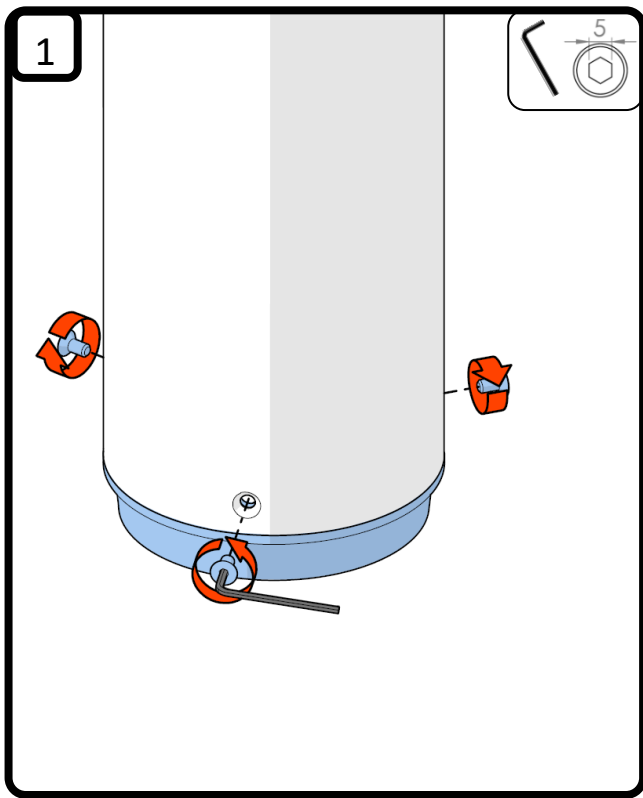

4

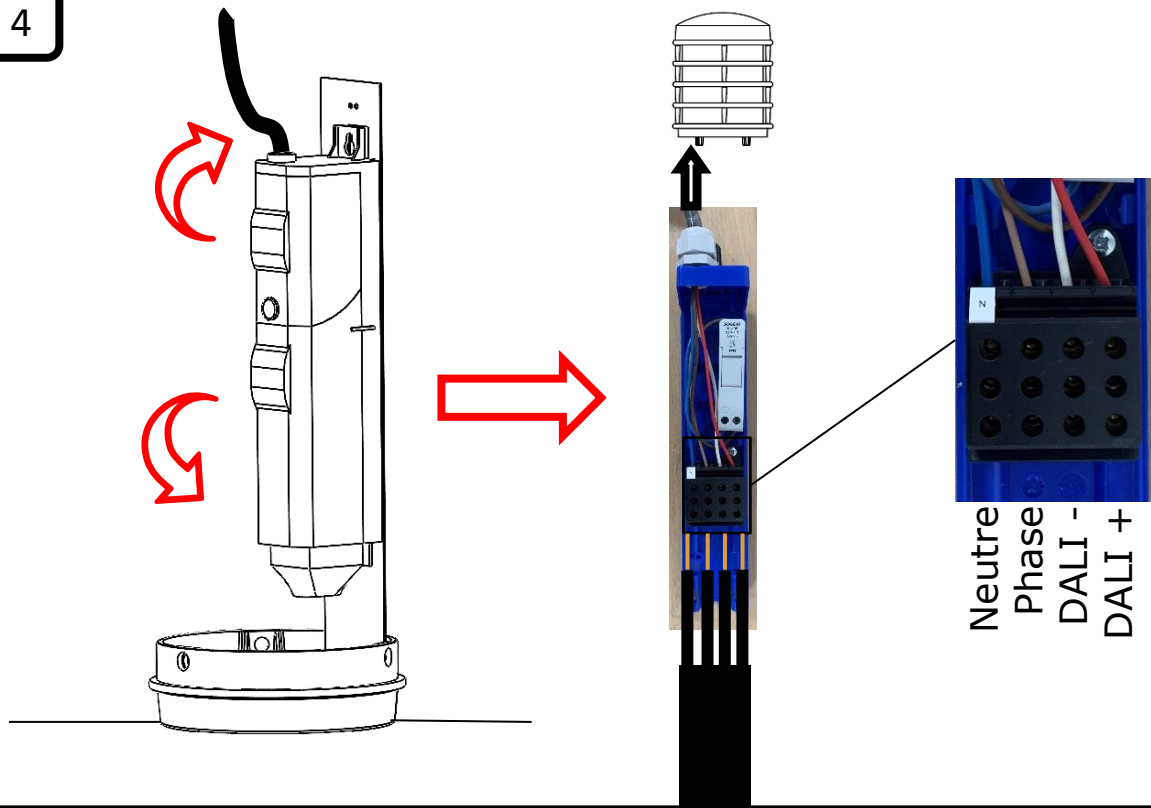

5

## Branchements au niveau du **coffret**

